

# soffioni

## shower heads

Ogni ambiente ha le sue caratteristiche, e ogni caratteristica trova il suo soffione: una vasta scelta di soffioni di diverse forme e misure, con installazione a parete o a soffitto, con erogazione dell'acqua classica o a cascata, ispezionabili o meno, ultrapiatti e con sistema anticalcare. Perché il benessere non conosca compromessi.

*Each environment has its own characteristics, where our shower-heads may be placed: a wide choice of shower-heads of different shapes and sizes, with ceiling or wall installation, with classic or cascade water flow, inspectable or not, ultra-thin and with anti-scale system. Because the well-being knows no compromise.*

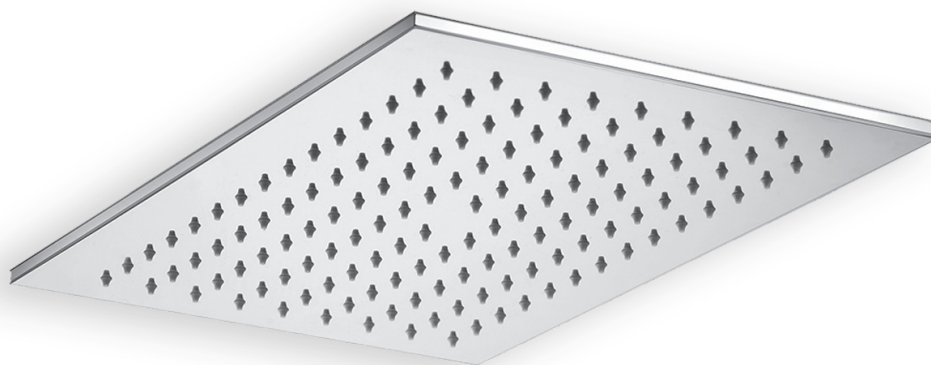

### FINITURE FINISHES

La serie **SOFFIONI** è disponibile nelle seguenti finiture:  
**SHOWER HEADS** range is available in the following finishes:

CR	cromato chrome plated	(per tutti gli articoli) (for all items)	HG	finitura Honey gold Honey gold finish	(solo per art. ZSOF079) (for art. ZSOF079 only)
BO	finitura bianco opaco matt white finish	(solo per artt. ZSOF074-075) (for artt. ZSOF074-075 only)	HGSP	finitura Honey gold spazzolato Brushed Honey gold finish	(solo per art. ZSOF079) (for art. ZSOF079 only)
NO	finitura nero opaco matt black finish	(solo per artt. ZSOF074-075-078-079) (for artt. ZSOF074-075-078-079 only)	BR	finitura bronzo bronze finish	(solo per art. ZSOF046) (for art. ZSOF046 only)
ST	finitura steel looking steel looking finish	(solo per artt. ZSOF074-075-079) (for artt. ZSOF074-075-079 only)			

# soffioni - shower heads

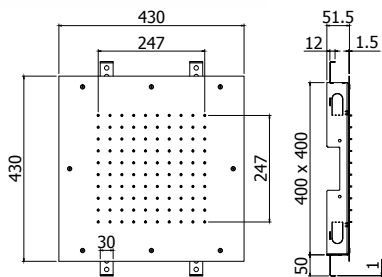

Soffione NEW YORK ad incasso "Quadro" in metallo:  
 • anticalcare  
 NEW YORK "Square" concealed ceiling metal shower head:  
 • antiscala system

**ZSOF 300 NEW YORK** ..... **Finiture - Finishes** **EUR**  
 430x430mm  
 430x430mm **CR**

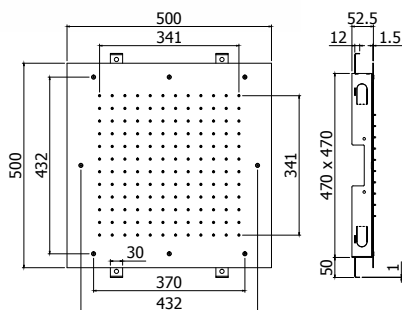

Soffione BOSTON ad incasso "Quadro" in metallo:  
 • anticalcare  
 BOSTON "Square" concealed ceiling metal shower head:  
 • antiscala system

**ZSOF 301 BOSTON** ..... **Finiture - Finishes** **EUR**  
 500x500mm  
 500x500mm **CR**

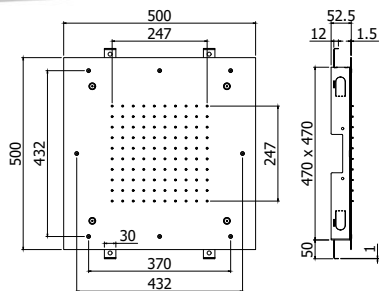

Soffione CLEVELAND ad incasso "Quadro" in metallo:  
 • anticalcare  
 CLEVELAND "Square" concealed ceiling metal shower head:  
 • antiscala system

**ZSOF 129 CLEVELAND** ..... **Finiture - Finishes** **EUR**  
 500x500mm  
 • con NEBULIZZATORE  
 500x500mm  
 • with NEBULIZER JETS

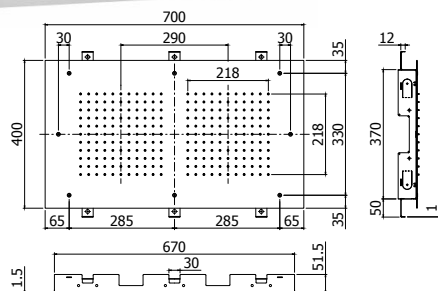

Soffione MIAMI ad incasso " Rettangolare" in metallo:  
 • anticalcare  
 LOS ANGELES "Rectangular" concealed ceiling metal shower head:  
 • antiscala system

**ZSOF 302 MIAMI** ..... **Finiture - Finishes** **EUR**  
 700x400mm  
 700x400mm **CR**

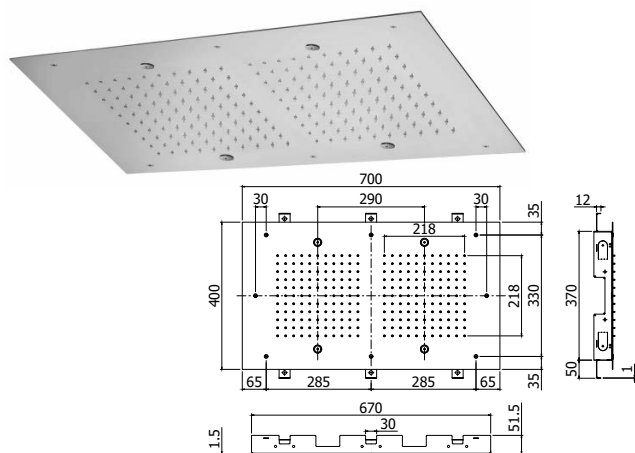

Soffione MEMPHIS ad incasso " Rettangolare" in metallo:

- anticalcare
- MEMPHIS "Rectangular" concealed ceiling metal shower head:
- antiscala system

**ZSOF 131 MEMPHIS** ..... **Finiture - Finishes** **EUR**  
**CR**

- 700x400mm
- con NEBULIZZATORE
- 700x400mm
- with NEBULIZER JETS

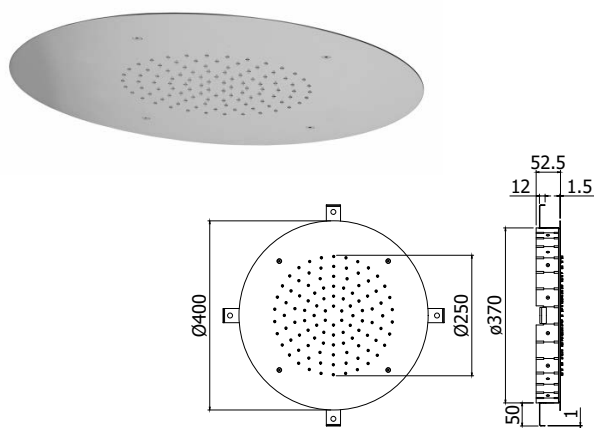

Soffione LOS ANGELES ad incasso "Tondo" in metallo:

- anticalcare
- LOS ANGELES "Round" concealed ceiling metal shower head:
- antiscala system

**ZSOF 303 LOS ANGELES** ..... **Finiture - Finishes** **EUR**  
**CR**

- Ø400mm
- Ø400mm

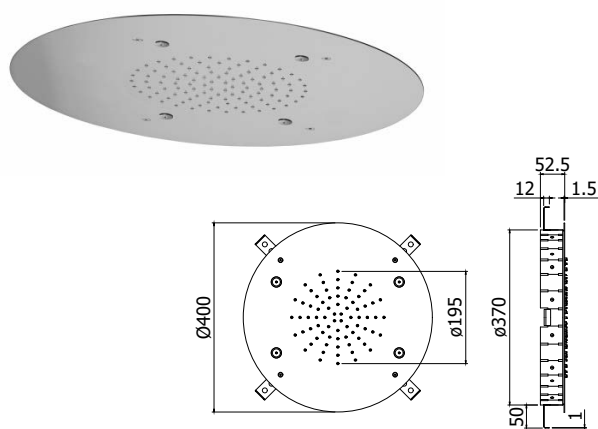

Soffione FILADELFIA ad incasso "Tondo" in metallo:

- anticalcare
- FILADELFIA "Round" concealed ceiling metal shower head:
- antiscala system

**ZSOF 130 FILADELFIA** ..... **Finiture - Finishes** **EUR**  
**CR**

- Ø400mm
- con NEBULIZZATORE
- Ø400mm
- with NEBULIZER JETS

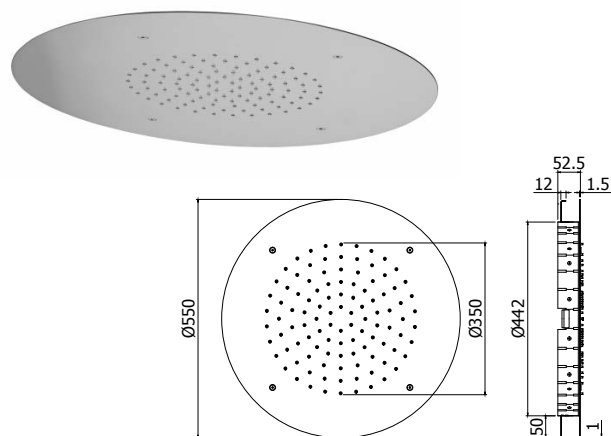

Soffione LAS VEGAS ad incasso "Tondo" in metallo:

- anticalcare
- LAS VEGAS "Round" concealed ceiling metal shower head:
- antiscala system

**ZSOF 304 LAS VEGAS** ..... **Finiture - Finishes** **EUR**  
**CR**

- Ø550mm
- Ø550mm



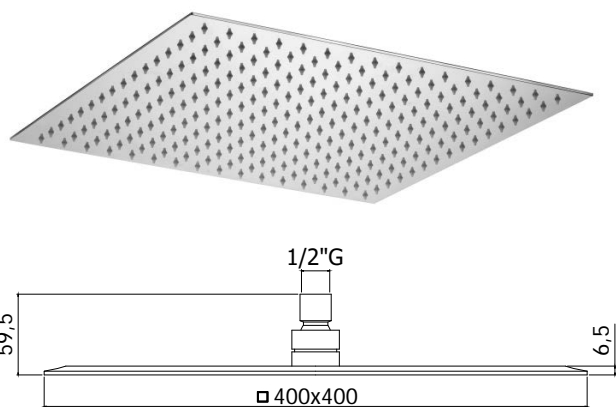

Soffione ORIGINAL "Quadro" in metallo:

- anticalcare
- ultrapiatto
- con snodo 1/2"G

ORIGINAL "Square" metal shower head:

- antiscala system
- ultra-thin
- 1/2"G swivel joint

**ZSOF 104 ORIGINAL**

non ispezionabile - 400x400mm  
not inspectable - 400x400mm

**Finiture - Finishes**      **EUR**  
CR

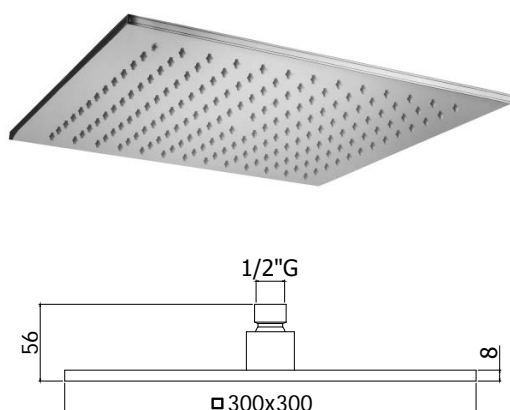

Soffione SYNCRO KING "Quadro" in metallo:

- anticalcare
- spessore 8mm
- con snodo 1/2"G

SYNCRO KING "Square" metal shower head:

- antiscala system
- 8mm thickness
- 1/2"G swivel joint

**ZSOF 078 SYNCRO KING**

ispezionabile - 300x300mm  
inspectable - 300x300mm

**Finiture - Finishes**      **EUR**  
CR  
NO  
ST

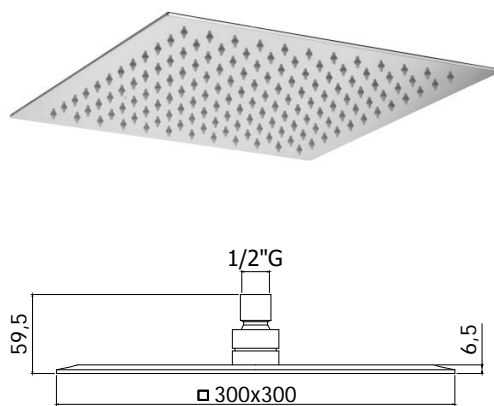

Soffione ZANZIBAR "Quadro" in metallo:

- anticalcare
- ultrapiatto
- con snodo 1/2"G

ZANZIBAR "Square" metal shower head:

- antiscala system
- ultra-thin
- 1/2"G swivel joint

**ZSOF 096 ZANZIBAR**

non ispezionabile - 300x300mm  
not inspectable - 300x300mm

**Finiture - Finishes**      **EUR**  
CR

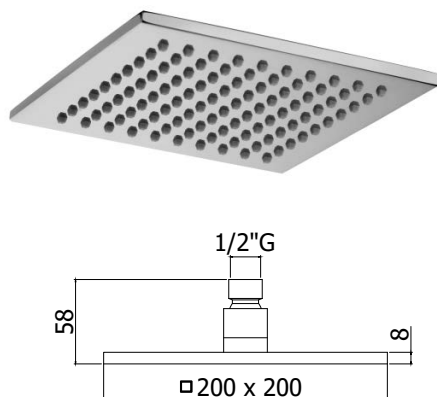

Soffione SYNCRO "Quadro" in metallo:

- anticalcare
- spessore 8mm
- con snodo 1/2"G

SYNCRO "Square" metal shower head:

- antiscala system
- 8mm thickness
- 1/2"G swivel joint

**ZSOF 075 SYNCRO**

ispezionabile - 200x200mm  
inspectable - 200x200mm

**Finiture - Finishes**      **EUR**  
CR  
BO  
NO  
ST

# soffioni - shower heads

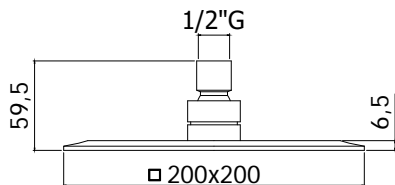
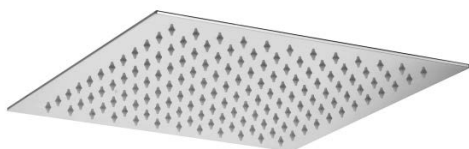

Soffione HAWAI "Quadro" in metallo:

- anticalcare
- ultrapiatto
- con snodo 1/2"G

HAWAI "Square" metal shower head:

- antiscala system
- ultra-thin
- 1/2"G swivel joint

**ZSOF 095 HAWAI**

non ispezionabile - 200x200mm  
not inspectable - 200x200mm

**Finiture - Finishes**    **EUR**  
**CR**

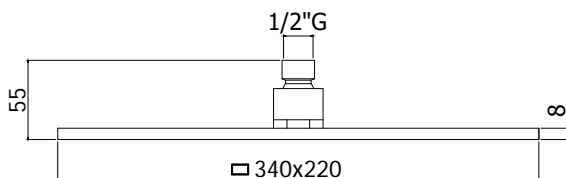
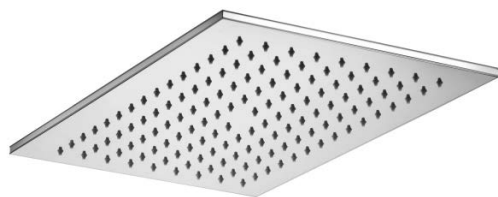

Soffione CITY " Rettangolare" in metallo:

- anticalcare
- spessore 8mm
- con snodo 1/2"G

CITY "Rectangular" metal shower head:

- antiscala system
- 8mm thickness
- 1/2"G swivel joint

**ZSOF 091 CITY**

ispezionabile - 340x220mm  
inspectable - 340x220mm

**Finiture - Finishes**    **EUR**  
**CR**

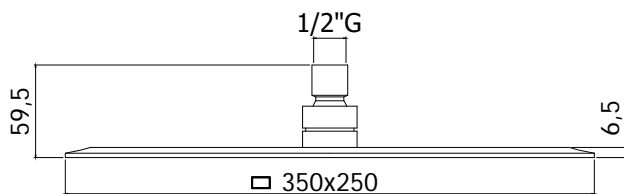
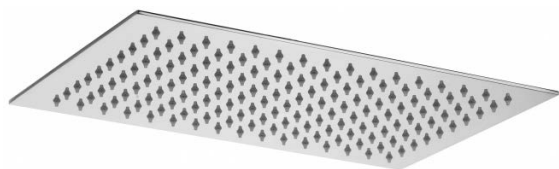

Soffione BLANC " Rettangolare" in metallo:

- anticalcare
- ultrapiatto
- con snodo 1/2"G

BLANC "Rectangular" metal shower head:

- antiscala system
- ultra-thin
- 1/2"G swivel joint

**ZSOF 102 BLANC**

non ispezionabile - 350x250mm  
not inspectable - 350x250mm

**Finiture - Finishes**    **EUR**  
**CR**

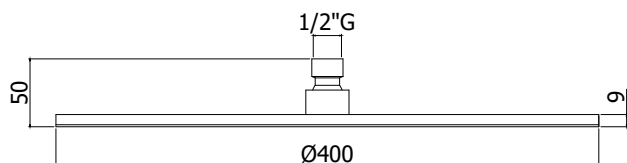

Soffione TURBO "Tondo" in metallo:

- anticalcare
- spessore 8mm
- con snodo 1/2"G

TURBO "Round" metal shower head:

- antiscala system
- 8mm thickness
- 1/2"G swivel joint

**ZSOF 082 TURBO**

ispezionabile - Ø400mm  
inspectable - Ø400mm

**Finiture - Finishes**    **EUR**  
**CR**

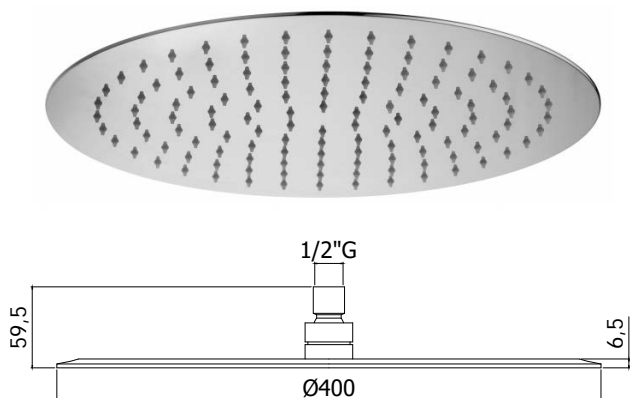

Soffione ENERGY "Tondo" in metallo:

- anticalcare
- ultrapiatto
- con snodo 1/2"G

ENERGY "Round" metal shower head:

- antiscala system
- ultra-thin
- 1/2"G swivel joint

**ZSOF 103 ENERGY**

non ispezionabile - Ø400mm  
not inspectable - Ø400mm

**Finiture - Finishes**    **EUR**  
**CR**

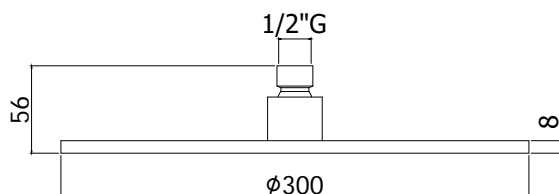

Soffione MASTER KING "Tondo" in metallo:

- anticalcare
- spessore 8mm
- con snodo 1/2"G

MASTER KING "Round" metal shower head:

- antiscala system
- 8mm thickness
- 1/2"G swivel joint

**ZSOF 079 MASTER KING**

ispezionabile - Ø300mm  
inspectable - Ø300mm

**Finiture - Finishes**    **EUR**  
**CR**  
**BO**  
**NO**  
**ST**  
**HG**  
**HGSP**

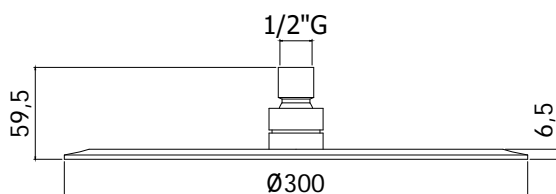
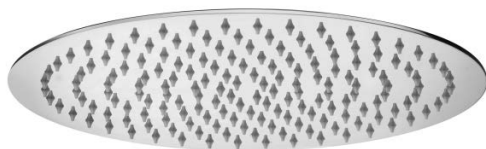

Soffione JAMAICA "Tondo" in metallo:

- anticalcare
- ultrapiatto
- con snodo 1/2"G

JAMAICA "Round" metal shower head:

- antiscala system
- ultra-thin
- 1/2"G swivel joint

**ZSOF 094 JAMAICA**

non ispezionabile - Ø300mm  
not inspectable - Ø300mm

**Finiture - Finishes**    **EUR**  
**CR**

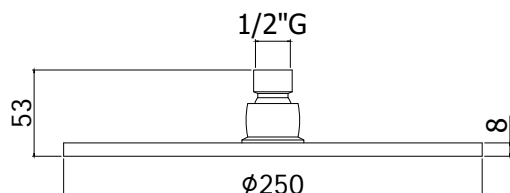

Soffione MASTER SPECIALE "Tondo" in metallo:

- anticalcare
- spessore 8mm
- con snodo 1/2"G

SPECIAL MASTER "Round" metal shower head:

- antiscala system
- 8mm thickness
- 1/2"G swivel joint

**ZSOF 101 MASTER SPECIALE**

ispezionabile - Ø250mm  
inspectable - Ø250mm

**Finiture - Finishes**    **EUR**  
**CR**



# soffioni - shower heads

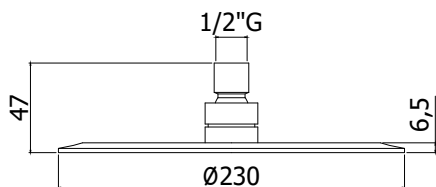
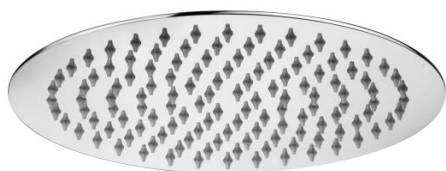

Soffione BAHAMAS "Tondo" in metallo:

- anticalcare
- ultrapiatto
- con snodo 1/2"G

BAHAMAS "Round" metal shower head:

- antiscala system
- ultra-thin
- 1/2"G swivel joint

**ZSOF 093 BAHAMAS**

non ispezionabile - Ø230mm  
not inspectable - Ø230mm

**Finiture - Finishes**      **EUR**  
CR

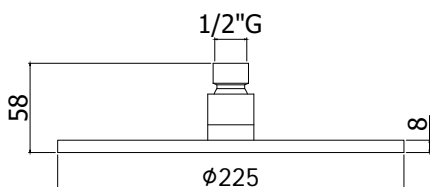
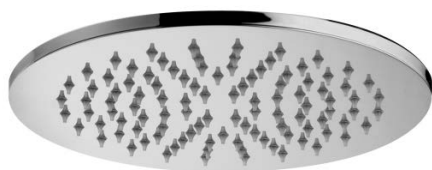

Soffione MASTER "Tondo" in metallo:

- anticalcare
- spessore 8mm
- con snodo 1/2"G

MASTER "Round" metal shower head:

- antiscala system
- 8mm thickness
- 1/2"G swivel joint

**ZSOF 074 MASTER**

ispezionabile - Ø225mm  
inspectable - Ø225mm

**Finiture - Finishes**      **EUR**  
CR  
BO  
NO  
ST

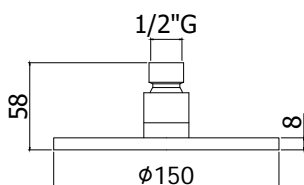

Soffione WIND "Tondo" in metallo:

- anticalcare
- spessore 8mm
- con snodo 1/2"G

WIND "Round" metal shower head:

- antiscala system
- 8mm thickness
- 1/2"G swivel joint

**ZSOF 092 WIND**

ispezionabile - Ø150mm  
inspectable - Ø150mm

**Finiture - Finishes**      **EUR**  
CR

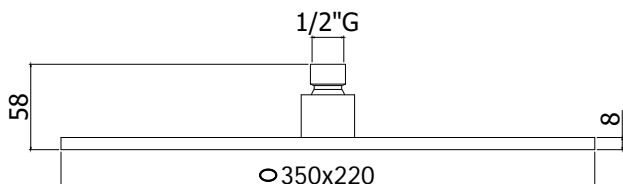

Soffione BERRY KING "Ellittico" in metallo:

- anticalcare
- spessore 8mm
- con snodo 1/2"G

BERRY KING "Oval" metal shower head:

- antiscala system
- 8mm thickness
- 1/2"G swivel joint

**ZSOF 080 BERRY KING**

ispezionabile - 350x220mm  
inspectable - 350x220mm

**Finiture - Finishes**      **EUR**  
CR



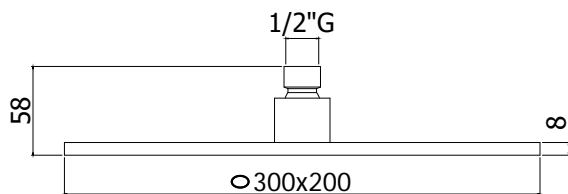

Soffione BERRY "Ellittico" in metallo:

- anticalcare
- spessore 8mm
- con snodo 1/2"G

BERRY "Oval" metal shower head:

- antiscala system
- 8mm thickness
- 1/2"G swivel joint

**ZSOF 077 BERRY**

ispezionabile - 300x200mm  
inspectable - 300x200mm

**Finiture - Finishes**    **EUR**  
**CR**

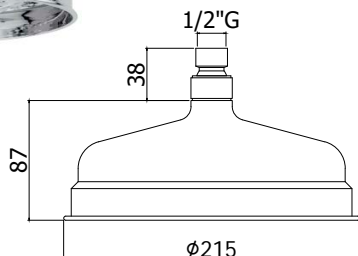

Soffione BELINDA in metallo:

- design Retrò
- con snodo 1/2"G

BELINDA metal shower head:

- Retrò design
- 1/2"G swivel joint

**ZSOF 046.. BELINDA**

Ø215mm  
Ø215 mm

**Finiture - Finishes**    **EUR**  
**CR**  
**BR**

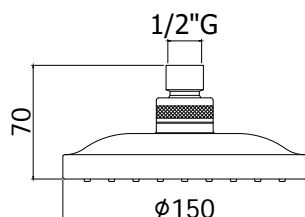

Soffione ARIZONA "Tondo" in ABS:

- anticalcare
- con snodo 1/2"G

ARIZONA "Round" ABS shower head:

- antiscala system
- 1/2"G swivel joint

**ZSOF 029 ARIZONA**

Ø150mm  
Ø150mm

**Finiture - Finishes**    **EUR**  
**CR**

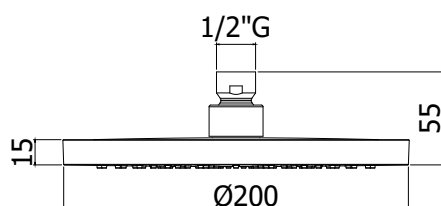

Soffione PANDA "Tondo" in ABS:

- anticalcare
- con snodo 1/2"G

PANDA "Round" ABS shower head:

- antiscala system
- 1/2"G swivel joint

**ZSOF 115 PANDA**

Ø200mm  
Ø200mm

**Finiture - Finishes**    **EUR**  
**CR**

# soffioni - shower heads

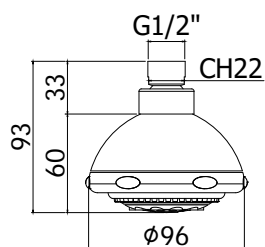

Soffione 3 getti ISCHIA in ABS:

- anticalcare
- con snodo 1/2"G

ISCHIA three-spray functions ABS:

- antiscala system
- 1/2"G swivel joint

**ZSOF 030 ISCHIA**

Ø96mm  
Ø96mm

**Finiture - Finishes**

**CR**

**EUR**

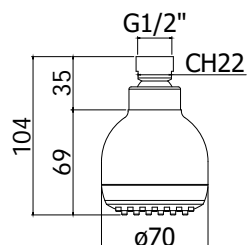

Soffione 2 getti ALABAMA in ABS:

- anticalcare
- con snodo 1/2"G

ALABAMA two-spray functions ABS:

- antiscala system
- 1/2"G swivel joint

**ZSOF 031 ALABAMA**

Ø70mm  
Ø70mm

**Finiture - Finishes**

**CR**

**EUR**

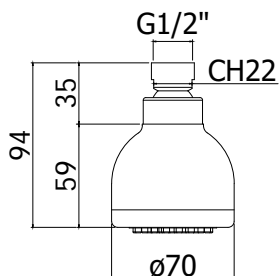

Soffione monogetto OREGON in ABS:

- anticalcare
- con snodo 1/2"G

OREGON single mode ABS shower head:

- antiscala system
- 1/2"G swivel joint

**ZSOF 032 OREGON**

Ø70mm  
Ø70mm

**Finiture - Finishes**

**CR**

**EUR**

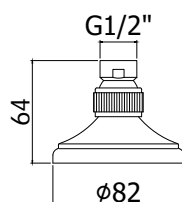

Soffione rotondo stampato in metallo:

- con snodo 1/2"G

Round metal shower head:

- 1/2"G swivel joint

**ZSOF 010**

Ø82mm  
Ø82mm

**Finiture - Finishes**

**CR**

**EUR**

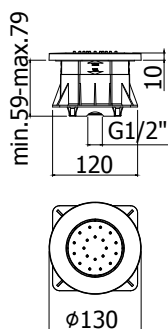

Soffione tondo in ABS:

- anticalcare
- getto orientabile
- con attacco 1/2" G

Round ABS shower head:

- antiscala system
- swivelling spray
- with 1/2" connection

**ZSOF 120**

Ø130mm  
Ø130mm

**Finiture - Finishes**      **EUR**

CR  
BO  
NO  
ST  
HG  
HGSP

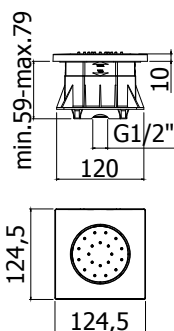

Soffione quadro in ABS:

- anticalcare
- getto orientabile
- con attacco 1/2" G

Square ABS body jet:

- antiscala system
- swivelling spray
- with 1/2" connection

**ZSOF 121**

124.5x124.5mm  
124.5x124.5mm

**Finiture - Finishes**      **EUR**

CR  
BO  
NO  
ST  
HG  
HGSP

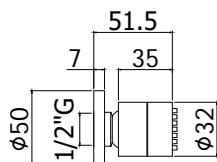
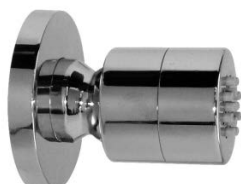

Soffione TONDO in metallo:

- anticalcare
- con rosone Ø50mm
- con snodo 1/2" G

Round metal shower head:

- antiscala system
- with wall plate Ø50mm
- 1/2" G swivel joint

**ZSOF 061**

Ø32mm  
• per getti laterali  
Ø32mm  
• for lateral jets

**Finiture - Finishes**      **EUR**

CR

**ZSOF 084**

Rosone TONDO - Ø50mm  
ROUND wall plate - Ø50mm

CR

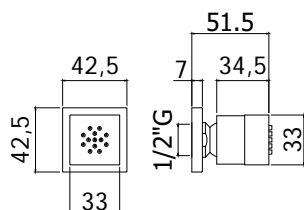

Soffione QUADRO in metallo:

- anticalcare
- con rosone 42.5x42.5mm
- con snodo 1/2" G

Square metal body jet:

- antiscala system
- with wall plate 42.5x42.5mm
- 1/2" G swivel joint

**ZSOF 062**

33x33mm  
• per getti laterali  
33x33mm  
• for lateral jets

**Finiture - Finishes**      **EUR**

CR

**ZSOF 085**

Rosone QUADRO - 42.5x42.5mm  
SQUARE wall plate - 42.5x42.5mm

CR

# soffioni - shower heads

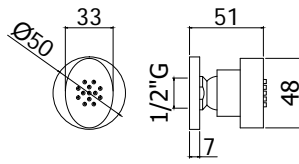

Soffione ELLITTICO in metallo:

- anticalcare
  - con rosone Ø50mm
  - con snodo 1/2" G
- Oval metal shower head:
- antiscala system
  - with wall plate Ø50mm
  - 1/2" G swivel joint

**ZSOF 073**

48x33mm  
 • per getti laterali  
 48x33mm  
 • for lateral jets

**Finiture - Finishes**      **EUR**  
 CR

**ZSOF 084**

Rosone TONDO - Ø50mm  
 ROUND wall plate - Ø50mm

CR

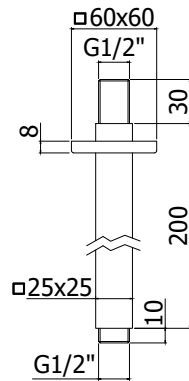

Braccio doccia a soffitto in metallo completo di:

- rosone quadro - 60x60mm
  - attacchi 1/2" G
- Ceiling metal shower arm complete with:
- square wall plate - 60x60mm
  - 1/2" G connections

**ZSOF 118**

con lunghezza l. 120mm  
 with length l. 120mm

**Finiture - Finishes**      **EUR**  
 CR

**ZSOF 119**

con lunghezza l. 200mm  
 with length l. 200mm

CR  
 NO

**ZSOF 076**

Rosone QUADRO - 60x60mm  
 SQUARE wall plate - 60x60mm

CR  
 NO

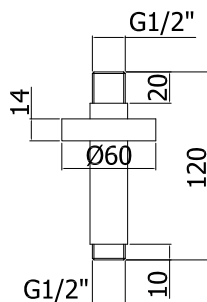

Braccio doccia a soffitto in metallo completo di:

- rosone tondo - Ø60mm
  - attacchi 1/2" G
- Ceiling metal shower arm complete with:
- round wall plate - Ø60mm
  - 1/2" G connections

**ZSOF 064**

con lunghezza l. 120mm  
 with length l. 120mm

**Finiture - Finishes**      **EUR**  
 CR  
 BO  
 NO  
 HG  
 HGSP  
 ST

**ZSOF 065**

con lunghezza l. 200mm  
 with length l. 200mm

CR  
 NO

**ZSOF 051**

Rosone TONDO - Ø60mm  
 ROUND wall plate - Ø60mm

CR  
 BO  
 NO  
 HG  
 HGSP  
 ST

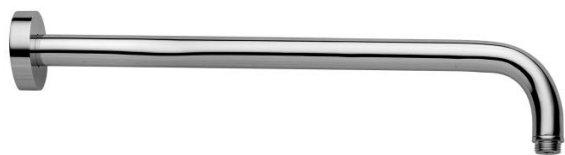

Braccio doccia LUSO completo di:  
 • rosone tondo - Ø60mm  
 • attacchi 1/2"G  
 Luxury shower arm complete with:  
 • round wall plate - Ø60mm  
 • 1/2"G connections

**ZSOF 034**

con lunghezza l. 400mm  
 with length l. 400mm

**Finiture - Finishes EUR**

CR  
 BO  
 NO  
 ST  
 BR  
 HG  
 HGSP

**ZSOF 035**

con lunghezza l. 300mm  
 with length l. 300mm

CR  
 NO  
 ST  
 BR

**ZSOF 051**

Rosone TONDO - Ø60mm  
 ROUND wall plate - Ø60mm

CR  
 BO  
 NO  
 ST  
 BR

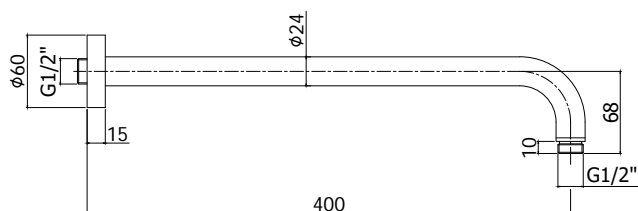

Braccio doccia lusso INCLINATO completo di:  
 • rosone tondo - Ø60mm  
 • attacchi 1/2"G  
 Luxury shower arm inclined complete with:  
 • round wall plate - Ø60mm  
 • 1/2"G connections

**ZSOF 038**

con lunghezza l. 200mm  
 with length l. 200mm

**Finiture - Finishes EUR**

CR

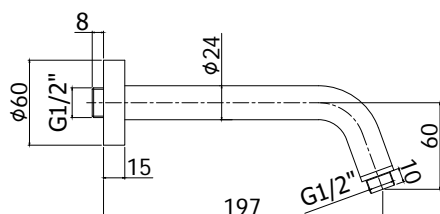

**ZSOF 051**

Rosone TONDO - Ø60mm  
 ROUND wall plate - Ø60mm

CR



Braccio doccia QUADRO completo di:  
 • rosone quadro - 60x60mm  
 • attacchi 1/2"G  
 SQUARE shower arm complete with:  
 • square wall plate - 60x60mm  
 • 1/2"G connections

**ZSOF 063**

con lunghezza l. 400mm  
 with length l. 400mm

**Finiture - Finishes EUR**

CR  
 BO  
 NO  
 ST

**ZSOF 063.. 350**

con lunghezza l. 350mm  
 with length l. 350mm

CR  
 ST

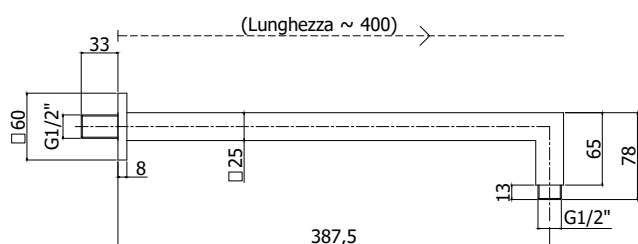

**ZSOF 076**

Rosone QUADRO - 60x60mm  
 SQUARE wall plate - 60x60mm

CR  
 ST  
 BO  
 NO

# soffioni - shower heads



Braccio doccia ELLITTICO completo di:  
 • rosone ellittico - 70x50mm  
 • attacchi 1/2"G  
 Oval shower arm complete with:  
 • oval wall plate - 70x50mm  
 • 1/2"G connections

## ZSOF 090

con lunghezza l. 350mm  
 with length l. 350mm

**Finiture - Finishes**    **EUR**  
 CR

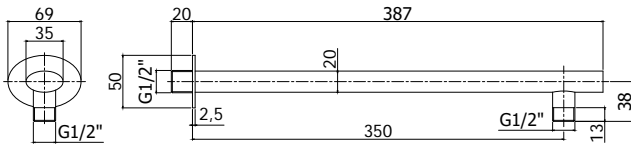

Braccio doccia MEDIO completo di:  
 • attacchi 1/2"G  
 MEDIO shower arm complete with:  
 • 1/2"G connections

## ZSOF 015

con lunghezza l. 155mm  
 • con attacco a muro 1/2"G (femmina)  
 with length l. 155mm  
 • with 1/2" wall connection (female)

**Finiture - Finishes**    **EUR**  
 CR



Braccio doccia tubo completo di:  
 • rosone - Ø60mm  
 • attacchi 1/2"G  
 Tube shower arm complete with:  
 • wall plate - Ø60mm  
 • 1/2"G connections

## ZSOF 016

con lunghezza l. 300mm  
 with length l. 300mm

**Finiture - Finishes**    **EUR**  
 CR

## ZSOF 017

con lunghezza l. 400mm  
 with length l. 400mm

**Finiture - Finishes**    **EUR**  
 CR

## ZSOF 018

con lunghezza l. 200mm  
 with length l. 200mm

**Finiture - Finishes**    **EUR**  
 CR

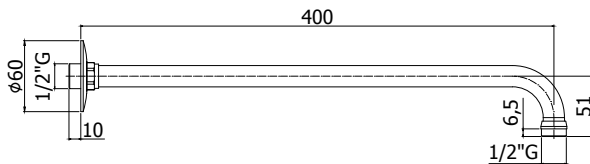

Ugelli anticalcare per soffioni inox  
 Antiscale nozzles for stainless steel shower heads

## ZACC444

per artt. 074-075-077-078-079-080-081-082-091-092-093-094-095-096-098-099-101-102-103-104-117-300-301-302-303-304

for artt. 074-075-077-078-079-080-081-082-091-092-093-094-095-096-098-099-101-102-103-104-117-300-301-302-303-304

**Finiture - Finishes**    **EUR**